



***GO blu Air***

User Manual

**Thank you for purchasing the blu Air from the GO series.** The **GO blu Air** is a Mobile Hi-Res Bluetooth Headphone DAC.

Take your wired headphones further with the GO blu Air. Built for everyday life, the GO blu Air is a simple, compact Bluetooth DAC that's always ready for your playlist. Its magnetic clip attaches securely to a bag or jacket, and the high-quality mic keeps calls clear.

Inside, we've done the heavy lifting – so taking headphones with you is an easy choice. Optimised Bluetooth, DAC, and amp stages work together to deliver powerful, balanced sound with no compromise, driving everything from IEMs to full-size headphones with authority.

## **FEATURES:**

- Connect wirelessly to phones, tablets, and computers with 24/96kHz Bluetooth
- Individually optimised Bluetooth, DAC, and amp stages for Hi-Fi performance
- Powerful amp delivers heavenly headphone sound on the go
- Cirrus Logic MasterHIFI DAC for dynamic sound with minimal battery drain
- XBass and XSpace – tune the bass and soundstage to your liking
- Symmetrical twin-mono amp with balanced 4.4mm output
- S-Balanced 3.5mm output halves distortion for single-ended headphones
- Snap-on magnetic clip - attach to your bag, strap, or jacket
- Built-in mic for hands-free calls on the move

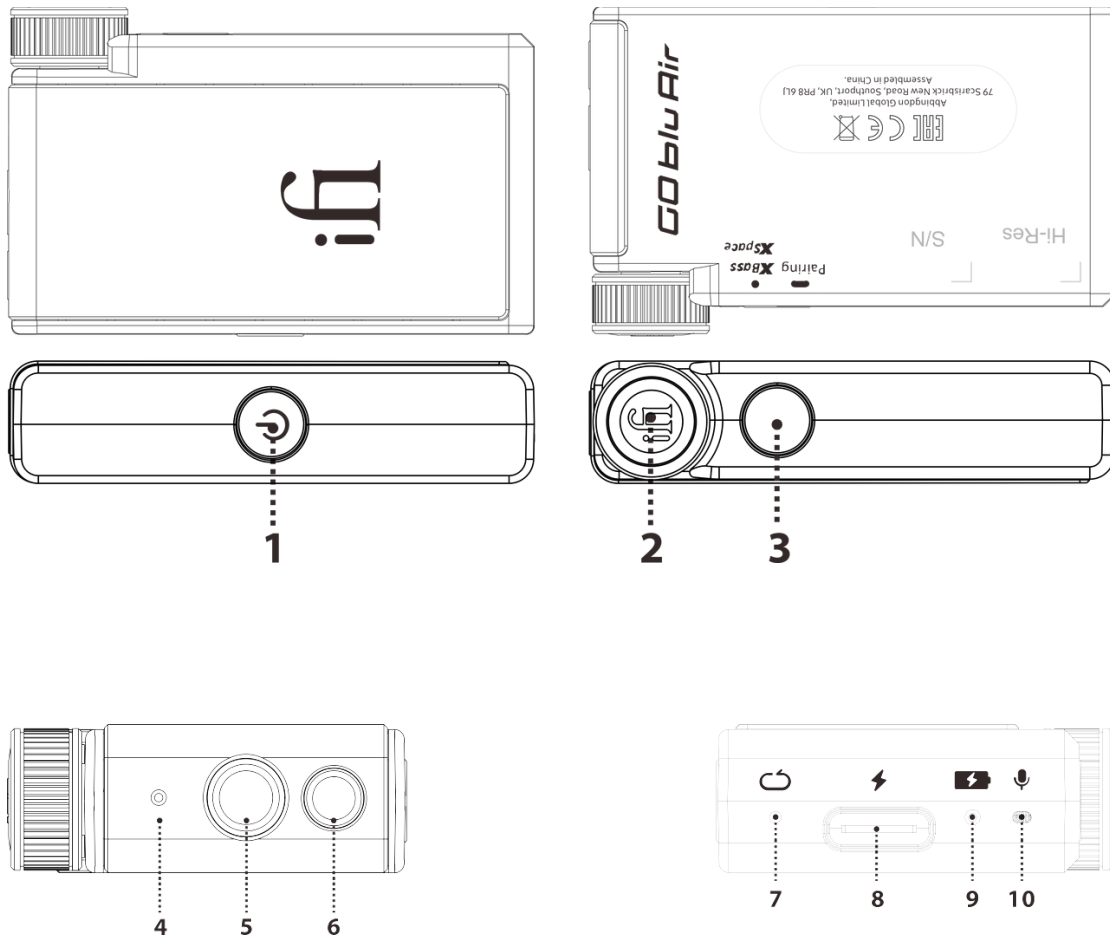

## Contents

1. Power Button
  - I) Power ON/OFF
  - II) Bluetooth Codec Announcement
  - III) Voice Announcement ON/OFF
  - VI) Digital Filter Selection Mode
2. ChronoDial (Multi-Function Control)
3. Settings Button
  - I) Analogue Filter Selection

II) Bluetooth Pairing Mode

III) Restore Factory Settings

4. Indicator LED

I) Analogue Filter Mode LED

II) Bluetooth Status LED

III) Digital Filter LED

VI) Restore Factory Settings LED

5. Balanced 4.4mm Headphone Output

6. S-Balanced 3.5mm Headphone Output

7. Factory Reset

8. USB-C Battery Charge Input

9. Battery Status LED

10. Microphone

Set up your Bluetooth connection using our iFi-Nexis APP

Cautions

SPECIFICATIONS:

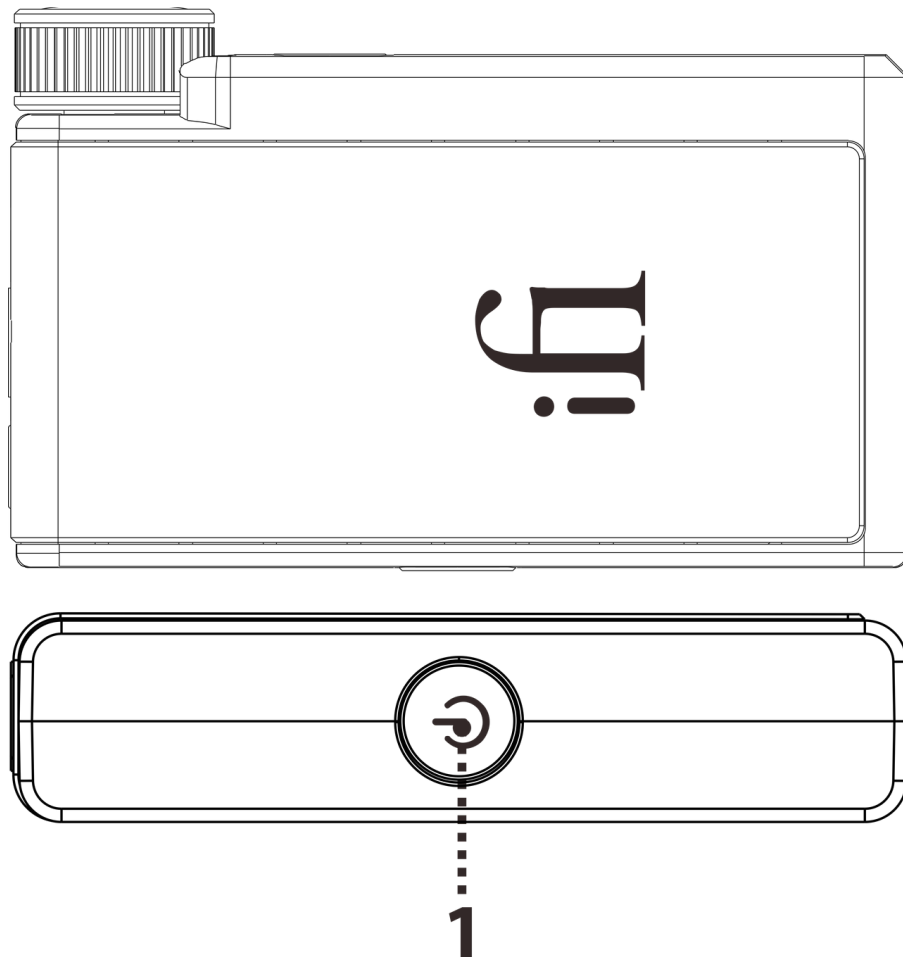

## 1. Power Button

- Power ON/OFF
- Bluetooth Codec Announcement
- Voice Prompt ON/OFF
- Digital Filter Selection Mode

### I) Power ON/OFF

Long press and hold the power button (1) for  $\geq 3s$  to power on/off the GO blu Air.

## **II) Bluetooth Codec Announcement**

Short press the power button (1) twice and the voice will announce the Bluetooth codec you are currently receiving.

## **III) Voice Announcement ON/OFF**

While powered off, first press and hold the settings button (3) without releasing it, then press the power button (1) to turn the GO blu Air on with the voice announcement setting adjusted.

The process for turning off and turning on voice announcement is the same. Voice announcement is on by default.

*Note: After turning off the voice announcement, the current Bluetooth codec and sampling frequency will no longer be announced.*

## **VI) Digital Filter Selection Mode**

To enter/exit digital filter selection mode, short press the power button (1) three times; a beep will sound, then press the settings button (3) to cycle filters. Short press the power button (1) three times again to confirm your selection - the current selection will also be confirmed if no button is pressed for 30 seconds. See (4) for digital filter LED colours.

<b>"STD"</b>	Standard: modest filtering, modest pre and post ringing
<b>"MIN"</b>	Minimum Phase: slow roll-off, minimum pre and post ringing

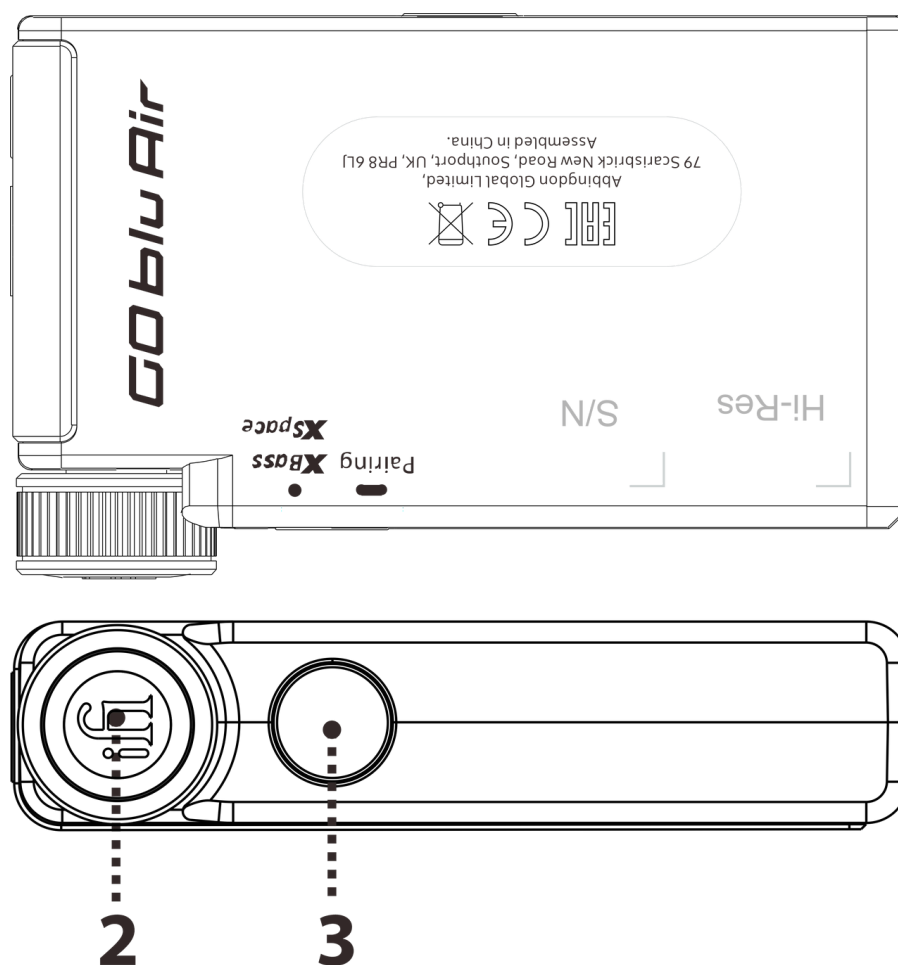

## 2. ChronoDial (Multi-Function Control)

### Controls:

- Volume Control (Turn)
- Play/Pause (Single Tap)

- Skip Forward (Double Tap)
- Skip Back (Triple Tap)
- Wake Voice Assistant (Long Press)

### **Answer Calls:**

- Answer Call (Short Press)
- Hang Up (Long Press)

## **3. Settings Button**

- Analogue Filter Selection
- Bluetooth Pairing
- Restore Factory Settings

### **I) Analogue Filter Selection**

Short press the settings button (3) to cycle between analogue filter modes. This button cycles between (See 4):

**Off > XBass > XSpace > XBass + XSpace**

### **II) Bluetooth Pairing Mode**

After powering on, the Bluetooth status LED (4) will blink blue as the GO blu Air searches for a previously paired device. If a stored device is not found, it will automatically enter pairing mode and blink blue/red.



To enter pairing mode, long press the settings button (3)  $\geq 3$ s until the Bluetooth status LED (4) is blinking blue/red. Then, on your audio source device (phone, tablet, etc.), search for 'GO blu Air' in the list of available Bluetooth devices.

The GO blu Air is able to store up to 8 paired Bluetooth devices. When the 9th device is paired, the oldest paired Bluetooth device will be removed from the pairing list and you may need to manually reconnect it when using it.

### **III) Restore Factory Settings**

Press and hold the settings button (3) for  $\geq 15$ s to restore factory settings. The restore factory settings LED (4) will flash white 3 times to confirm factory settings have been restored.

*Note: The device must be powered on while restoring factory settings, during which time no other operations can be performed. When process is complete, the white light will flash 3 times with a beep sound. After the operation is successful, the device will be powered on.*

*Warning: Restoring the factory settings will clear all previously paired Bluetooth devices, XBass and XSpace will be turned off, and voice announcement will be turned on.*

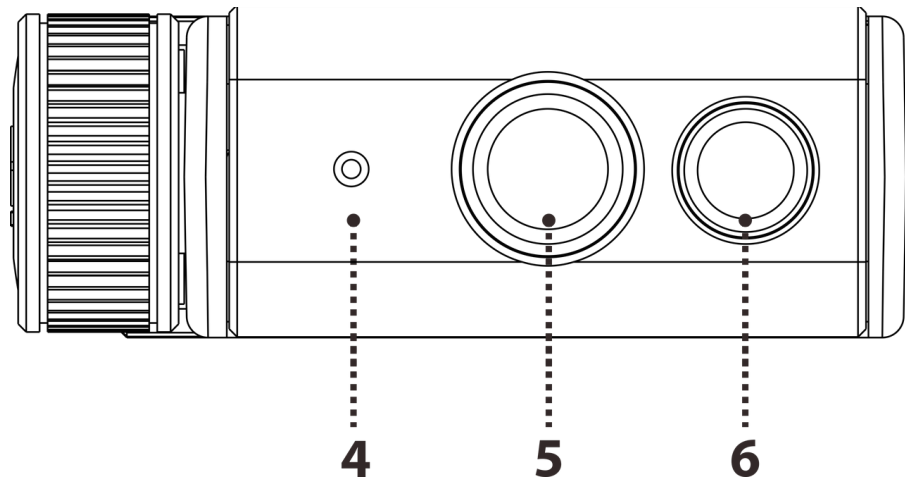

## 4. Indicator LED

- Analogue Filter Mode LED
- Bluetooth Status LED
- Digital Filter LED
- Restore Factory Settings LED

### I) Analogue Filter Mode LED

The LED colour scheme indicates the current analogue filter mode of the GO blu Air.

LED	Mode
Yellow	XBass
Cyan	XSpace
White	XBass + XSpace
Off	-

## II) Bluetooth Status LED

The LED colour represents the current Bluetooth connection status:

LED	Status
Off	Connected
Red/Blue (flashing)	Pairing
Blue (flashing)	Awaiting connection

## III) Digital Filter LED

The LED colour represents the current digital filter:

LED	Filter
Green	STD
Magenta	MIN

## VI) Restore Factory Settings LED

LED	Status
White	Restore Factory Settings

## 5. Balanced 4.4mm Headphone Output

Connect balanced 4.4mm headphones.

## 6. S-Balanced 3.5mm Headphone Output

Connect 3.5mm headphones (compatible with standard TRS configuration).

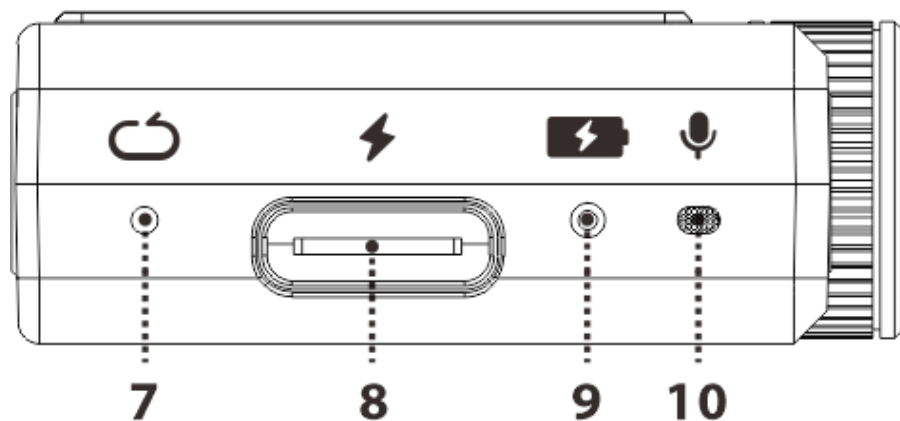

## 7. Factory Reset

While the GO blu Air is powered on, long press the factory reset button (7) to complete a factory reset of the device. Once completed, the device will restart.

## 8. USB-C Battery Charge Input

For charging only. It will take <40 minutes for a high powered USB charger to fully charge GO blu Air. Use the enclosed 'USB-A' to 'USB-C' cable, smart charger or a regular charger up to 6.3V.

## 9. Battery Status LED

LED	Status
Green*	51%-100%
Yellow	20%-50%
Red	≤19%

*\*The battery status LED will flash when the device is charging and will go out when it is fully charged.*

## 10. Microphone

Built-in microphone for hands-free calls when paired with a compatible Bluetooth device.

*Note: To wake up your phone's voice assistant, long-press the multi-function control (2).*



"iFi Nexis"



**Download the Nexis app for added features and future updates**

## Set up your Bluetooth connection using our iFi-Nexis APP

Please search for "GO blu Air" within the iFi Nexis app.

The iFi Nexis app gives you access to all GO blu Air's features and settings, including OTA upgrades\*, Bluetooth codecs, firmware version information, and more.

*\*OTA (Over-the-Air) technology Enableds firmware updates via the network.*



**Scan the QR code to view the official iFi audio GO blu Air video on YouTube.**

## Cautions

1. Avoid extreme heat, cold and humidity.

2. Avoid dropping or crushing the GO blu Air.

## SPECIFICATIONS:

<b>Bluetooth version</b>	Bluetooth 5.2
<b>Chipset</b>	Qualcomm QCC 5100 Series
<b>Connection distance:</b>	10 m
<b>Input</b>	Bluetooth 5.2 (aptX Adaptive, aptX HD, aptX, LDAC, LHDC(HWA), AAC and SBC)
<b>Headphone Output</b>	Balanced 4.4mm; S-Balanced 3.5mm*
<b>Maximum supported sampling rate</b>	96kHz/24Bit
<b>^Output Power (Max)</b>	
Balanced	3.1V/300mW @ 32Ω; 5.7V/108mW @ 300Ω
S-Balanced	2.4V/180mW @ 32Ω; 3.0V/30mW @ 300Ω
<b>Output Power (RMS)</b>	

Balanced	$\geq 262\text{mW}/2.9\text{V @ } 32\Omega$ ; $\geq 52\text{mW}/5.6\text{V @ } 600\Omega$
S-Balanced	$\geq 165\text{mW}/2.3\text{V @ } 32\Omega$ ; $\geq 14\text{mW}/2.9\text{V @ } 600\Omega$
<b>Output Impedance:</b>	$\leq 1\Omega$
<b>SNR:</b>	$\geq 110\text{dBA}$
<b>DNR:</b>	$\geq 110\text{dBA}$
<b>THD + N:</b>	
Balanced:	$< 0.009\%$ (6.5mW/2.0V @ 600 $\Omega$ )
S-Balanced:	$< 0.03\%$ (100mW/1.27V @ 16 $\Omega$ )
<b>Frequency Response:</b>	20-40kHz (-3dB) via LDAC
<b>Battery:</b>	Lithium-polymer 450mAh
<b>Battery Life</b>	$\geq 10$ Hours
<b>Charging time:</b>	$\leq 40$ mins
<b>Power System:</b>	5V/ $\geq 1\text{A}$ , Charging via USB-C
<b>Dimensions:</b>	53.5 x 33.7 x 19.5 mm (2.11" x 1.33" x 0.77")
<b>Net Weight:</b>	31 g (1.09 lbs)
<b>Limited Warranty:</b>	12 months



*\*12 months typical or as permitted/required by local reseller laws.*

*\*\*Specifications are subject to change without notice.*

*^See FAQ at [ifi-audio.com](http://ifi-audio.com) for more information.*

Qualcomm aptX and Snapdragon Sound are products of Qualcomm Technologies, Inc. and/or its subsidiaries.

Qualcomm, Snapdragon and Snapdragon Sound are trademarks or registered trademarks of Qualcomm Incorporated.

aptX is a trademark of Qualcomm Technologies International, Ltd.

LDAC and the LDAC Logo are trademarks of the Sony Corporation.